

# RSIC ACOUSTIC ASSEMBLY

## FLOOR CEILING ASSEMBLY

### DIRECT FIX TO WOOD OPEN WEB TRUSS



Toll Free 866-774-2100 • Telephone 503-649-7700

**TFCSW RAL IN09-044 STC 54 IIC 52**

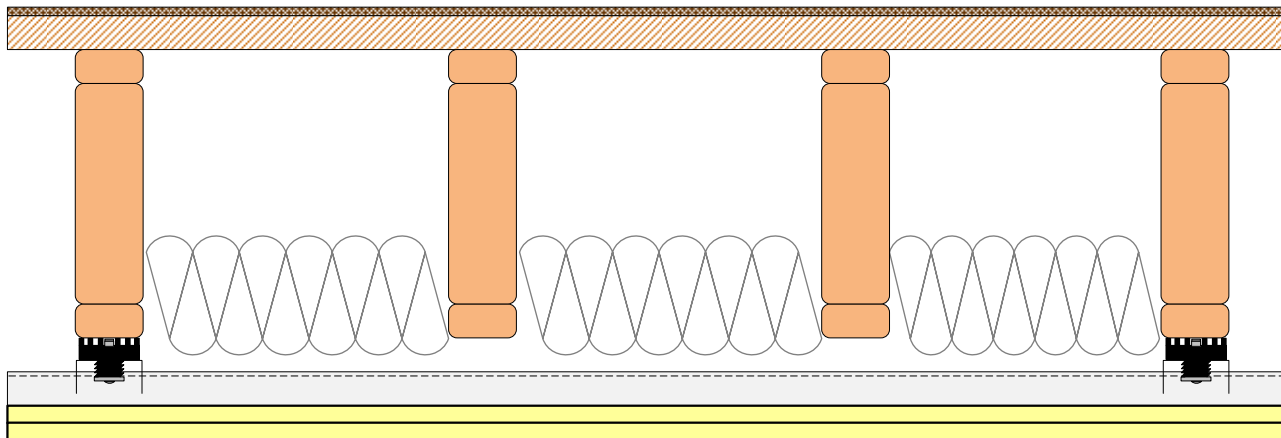

**Fire Resistance Ratings**

Designs:  
L528, L534, L542, L546,  
L562, ITS TSC60-01

### CONSTRUCTION

- HARDWOOD FLOORING
- 1/16" FOAM UNDERLAYMENT
- 3/4" T&G OSB SUBFLOOR
- 11-1/4" DEEP OPEN WEB TRUSS @ 24" OC
- R-11 FIBERGLASS BATT INSULATION (NOM 3.5")
- RSIC-1 INSTALLED @ 48" OC
- 7/8" DRYWALL FURRING CHANNEL @ 24" OC
- 2 LAYERS 5/8" FIRE CODE GYPSUM BOARD



**STC 54**

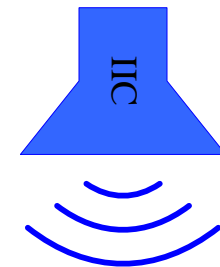

**IIC 52**

**RAL TEST IN09-044 & TL09-243**