

RSIC ACOUSTIC ASSEMBLY

FLOOR CEILING ASSEMBLY

DIRECT FIX TO SOLID WOOD JOIST



Toll Free 866-774-2100 • Telephone 503-649-7700

FCWT RAL IN08-015

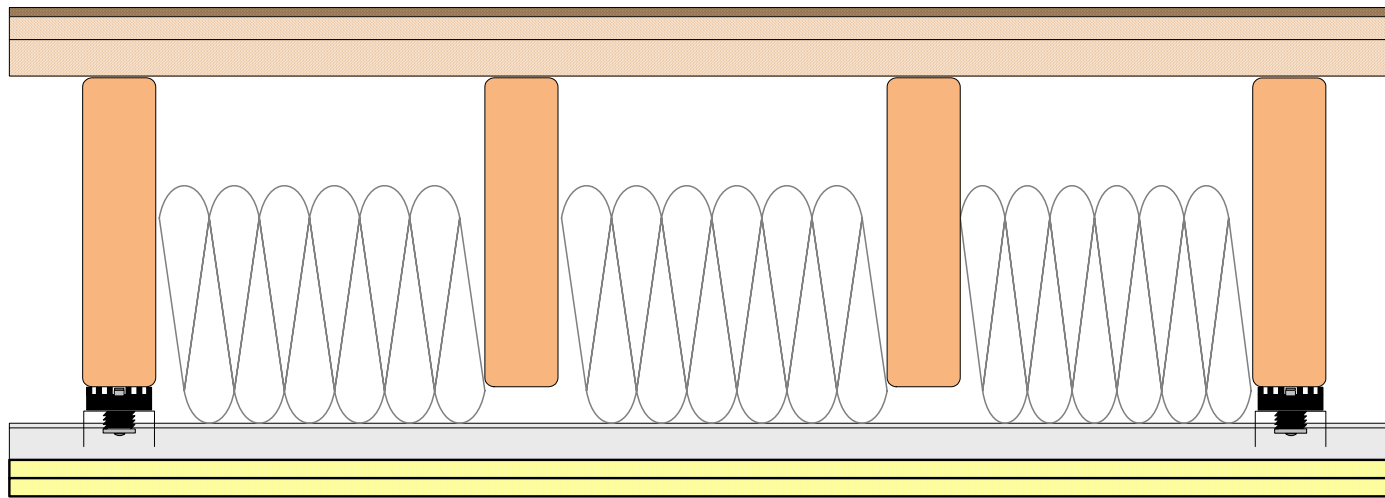

Fire Resistance Ratings

Designs:
L502, *L513 L514, L516,
L569, L590, L593

CONSTRUCTION

- LAMINATE HARD WOOD FLOORING
- VAPOR BARRIER
- 1/2" WOOD UNDERLAYMENT
- 5/8" PLYWOOD SUBFLOOR (*L513 – 3/4" Ply)
- 2" X 10" SOLID WOOD JOIST @ 16" OC
- R-19 FIBERGLASS BATT INSULATION (NOM 6")
- RSIC-1 INSTALLED @ 48" OC
- 7/8" DRYWALL FURRING CHANNEL @ 24" OC
- 2 LAYERS 5/8" FIRE CODE GYPSUM BOARD



RAL TL08-194
STC 57

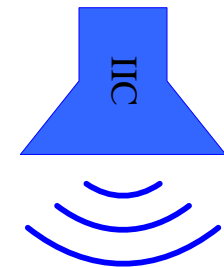

RAL IN08-015
IIC 52

RIVERBANK ACOUSTICAL LABORATORIES (RAL)