

RSIC ACOUSTIC ASSEMBLY

FLOOR CEILING ASSEMBLY

DIRECT FIX TO SOLID WOOD JOIST



Toll Free 866-774-2100 • Telephone 503-649-7700

FCWT RAL IN09-011

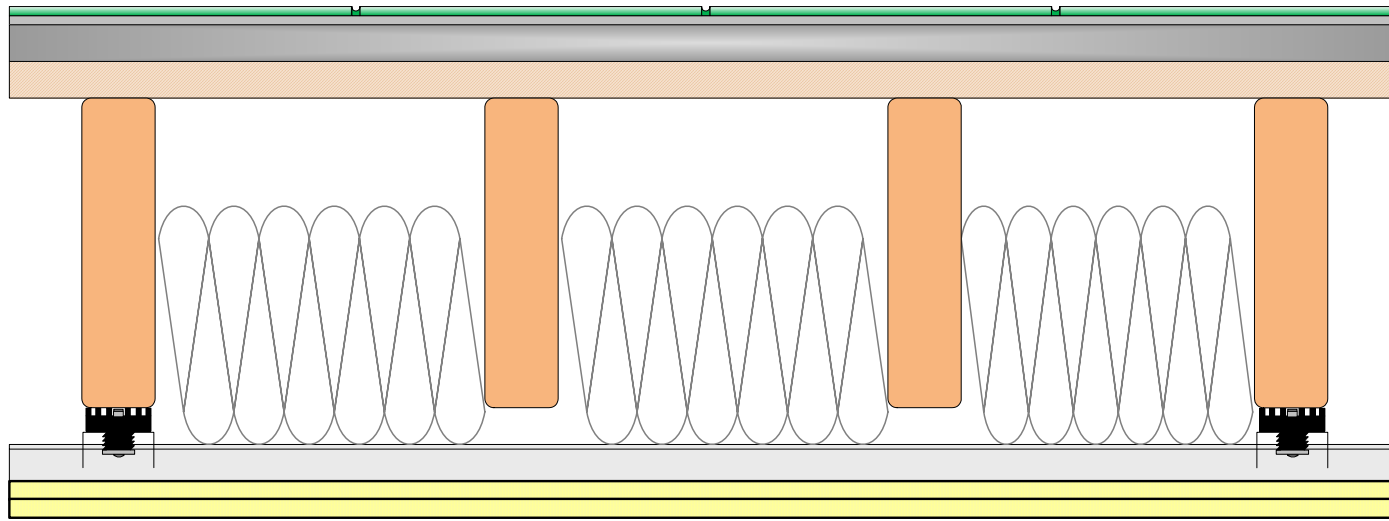

CONSTRUCTION

- CERAMIC TILE
- 1/4" TILE UNDERLAYMENT
- 3/4" LT WT CONCRETE
- 5/8" PLYWOOD SUBFLOOR
- 2" X 10" SOLID WOOD JOIST @ 16" OC
- R-19 FIBERGLASS BATT INSULATION (NOM 6")
- RSIC-1 INSTALLED @ 48" OC
- 7/8" DRYWALL FURRING CHANNEL @ 24" OC
- 2 LAYERS 5/8" FIRE CODE GYPSUM BOARD



Fire Resistance Ratings

Designs:
L502, L514, L516, L523,
L532, L569, L590, L593



RAL TL09-042
STC 55

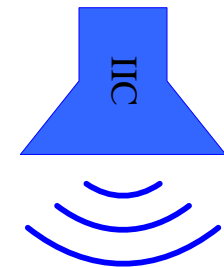

RAL IN09-011
IIC 53

RIVERBANK ACOUSTICAL LABORATORIES (RAL)